

## FIG. 231CT

### TWO HOLE STRAP FOR COPPER TUBING

TUBE SIZE	TUBE OD	A HOLE SIZE	B	C	WGT EACH (lbs)
1/4	0.375	3/16	1-13/16	1-3/16	0.01
3/8	0.500	3/16	1-15/16	1-5/16	0.01
1/2	0.625	3/16	2-1/8	1-1/2	0.01
3/4	0.875	3/16	2-5/16	1-11/16	0.02
1	1.125	3/16	2-7/16	2-1/4	0.02
1-1/4	1.375	3/16	3-1/8	2-1/2	0.04
1-1/2	1.625	7/16	3-11/16	2-13/16	0.05
2	2.125	7/16	4-1/4	3-3/8	0.06

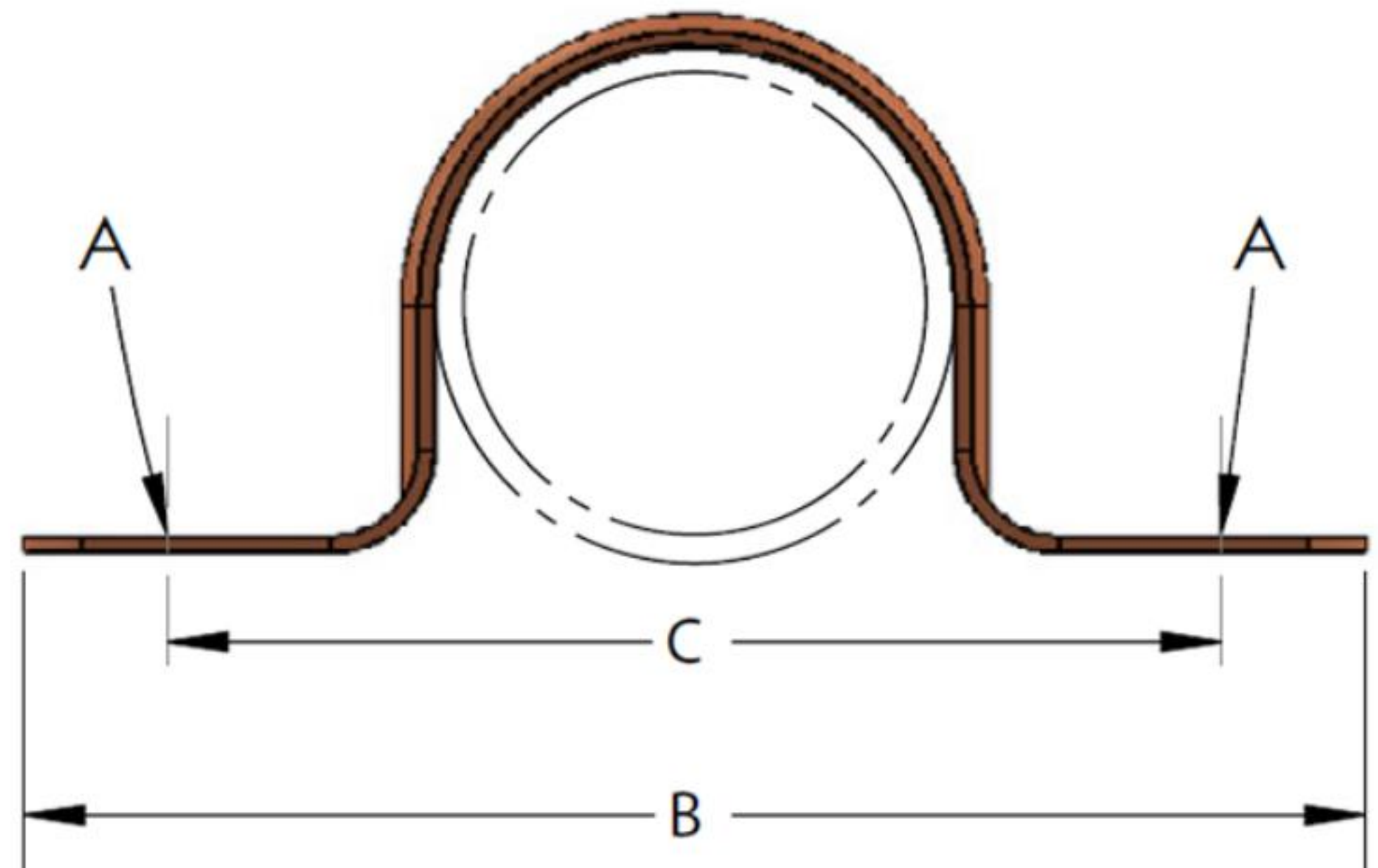

Materials/Finishes:	Copper Epoxy Coated <i>Copper Gard</i> (231CT)
Variants:	N/A
Service:	Designed as a light duty support for copper tubing. Attaches directly to horizontal or vertical structural member
Approvals:	Complies with Manufacturers' Standardization Society MSS SP-58 & SP-69 (Type# 26)
Ordering:	Specify figure number and tube size
Notes:	Available domestic